

1

2

3

4

5

REVISION TABLE					
REV	ECN#	DESCRIPTION	REV BY	APPROVED	DATE
---	---	Original Drawing	OOG	FGW	8-1-10

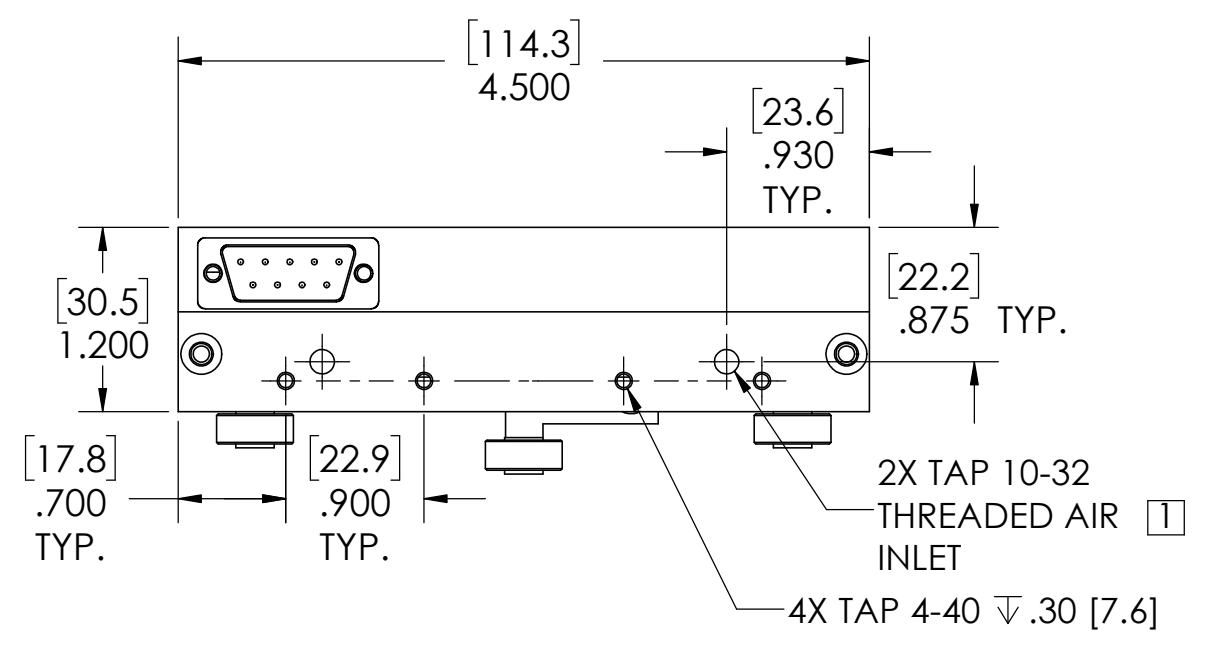
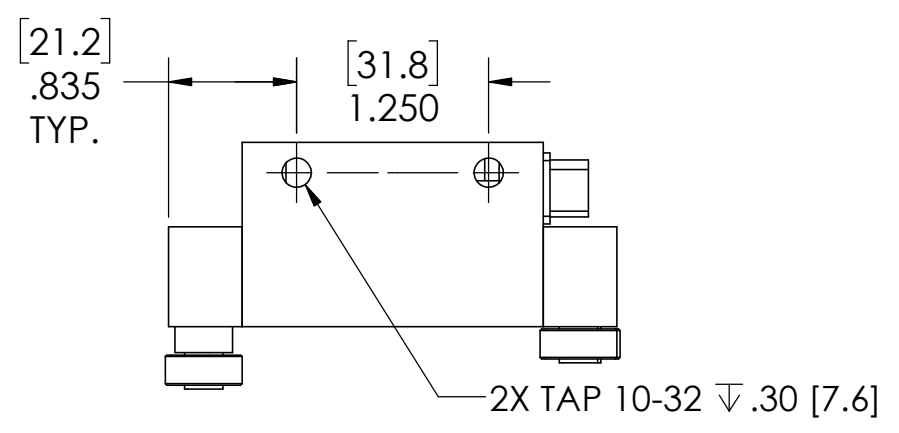
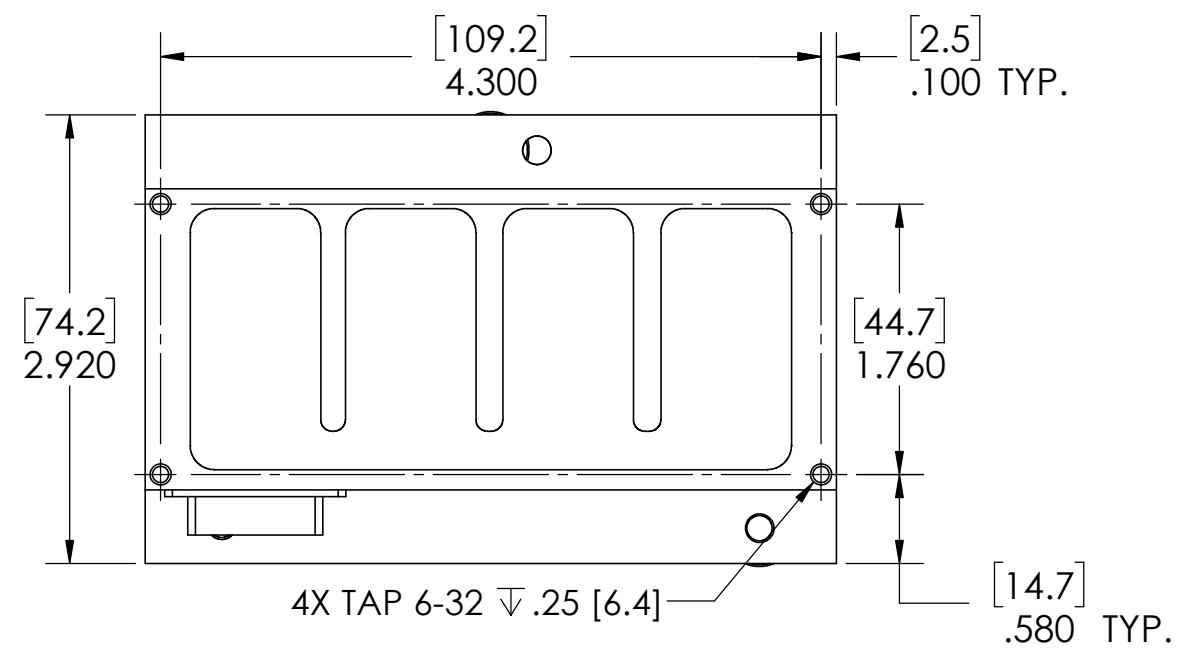
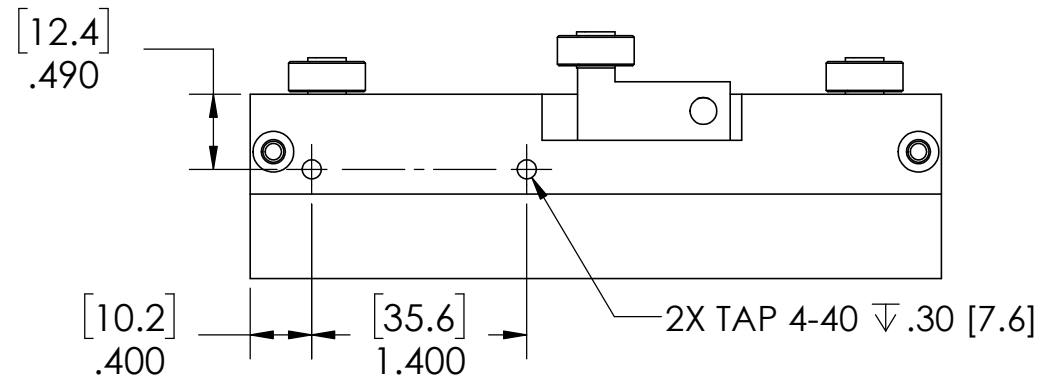

A

A

B

B

C

C

D

D

# COMPATIBLE PLATEN SPECIFICATIONS

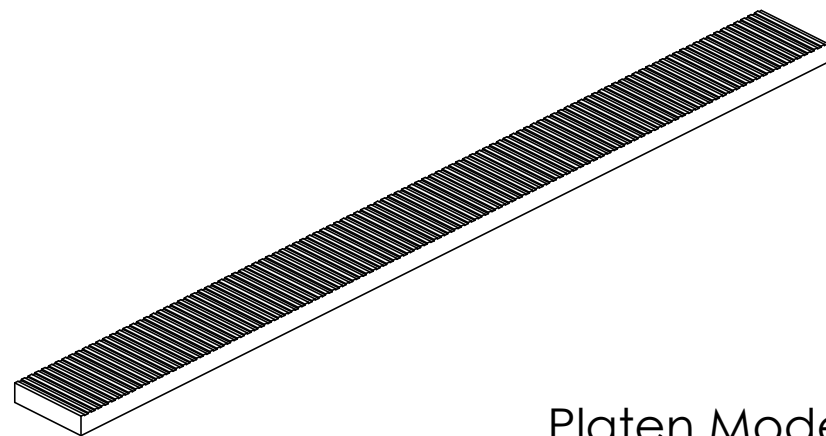
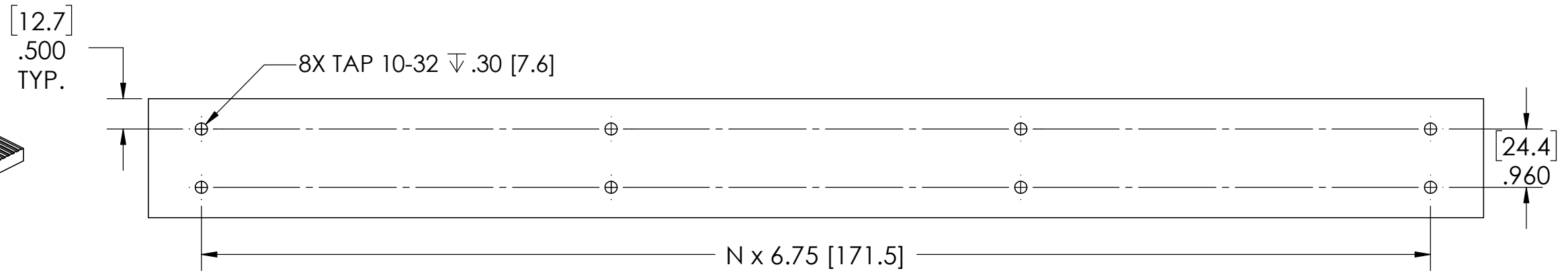
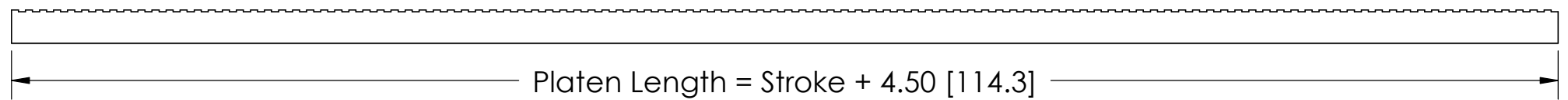
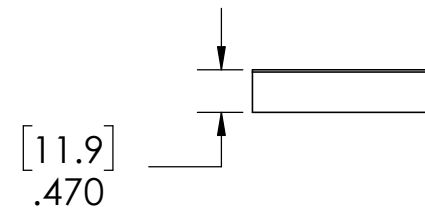
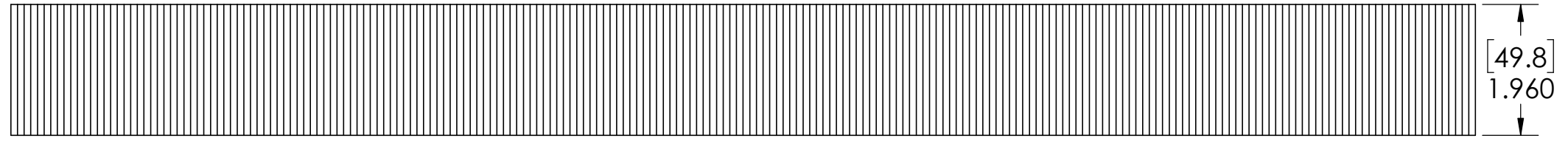

Platen Model #: STP-20-XXX-A

# MOTOR SHOWN MOUNTED ON PLATEN

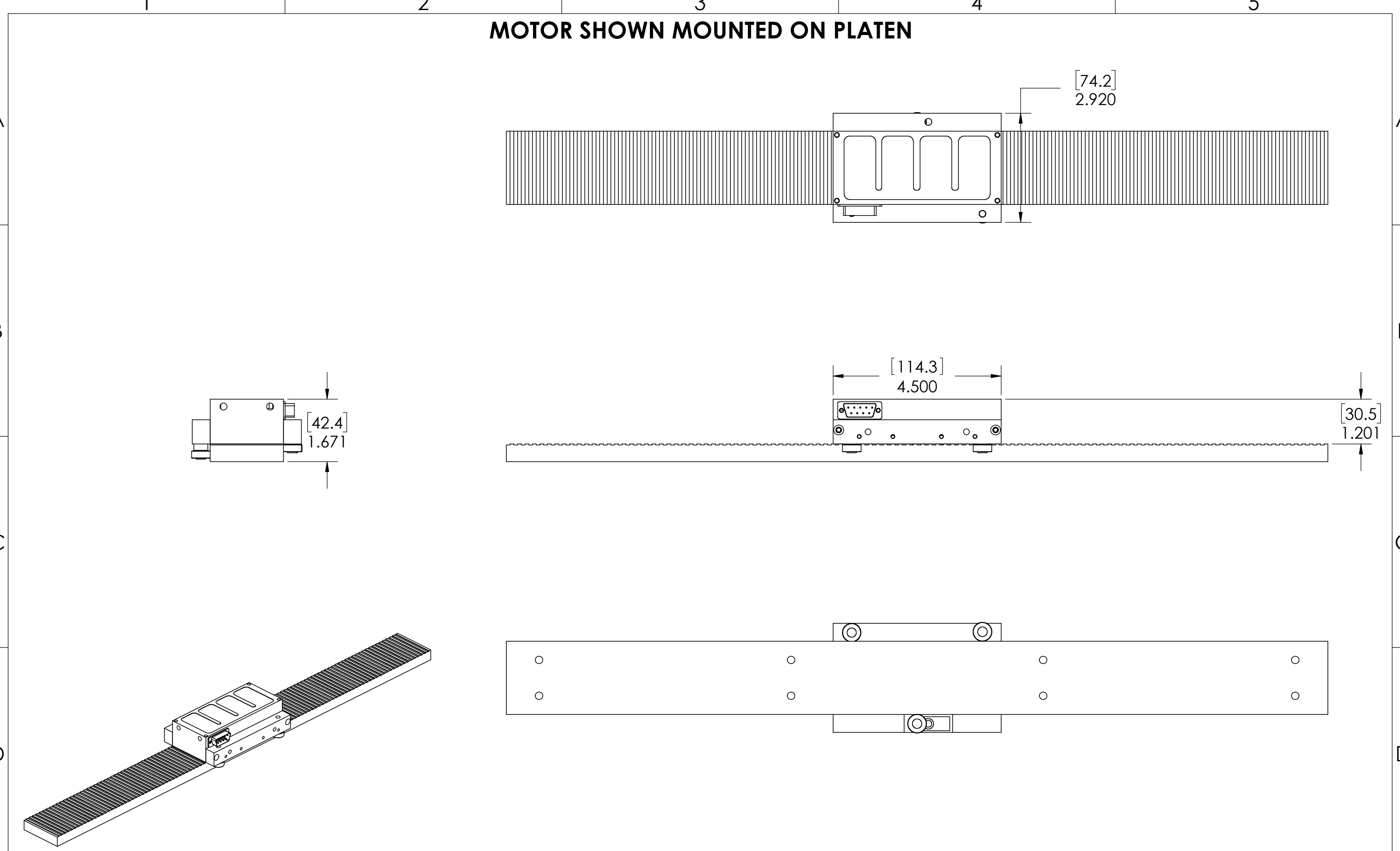

**H2W Technologies, Inc.**  
 Santa Clarita, CA 91350 USA  
 Tel: (661) 291-1620  
[www.h2wtech.com](http://www.h2wtech.com)

These drawings and specifications are the property of H2W Technologies, Inc. They are issued in confidence and shall not be reproduced, copied, or used without written permission from H2W Technologies, Inc.

UNLESS SPECIFIED OTHERWISE:  
 All dimensions are in inches  
 Standard Tolerances are as follows  
 .XXX ±.005 ANGLES ±.1°  
 .XX ±.010 FILLETS .010  
 .X ±.020 CORNERS .010  
 Remove All Burrs and Sharp Edges

**FOR  
 REFERENCE  
 ONLY**

MATERIAL	
FINISH	

TITLE	Single Axis Stepper Model #: <b>STS-1220-A4U</b>
-------	---

DWG #	<b>10-0464</b>
REV	----
DATE	8-1-10
SHEET	3 of 4

### LINEAR STEPPER MOTOR SPECIFICATIONS

Motor P/N	STS-1220-A4U	
Continuous Force	11.0 LBS	48.8 N
Rated Current/Phase	2.0 Amp	
Resistance/Phase @ 20C	2.24 ohms	
Inductance/Phase @ 20C	1.30 mH	
Motor Phases	4	
Bearing Type	Air Bearing	
Nominal Air Pressure	60 psi	
Motor Mass	1.0 lb	454 grams

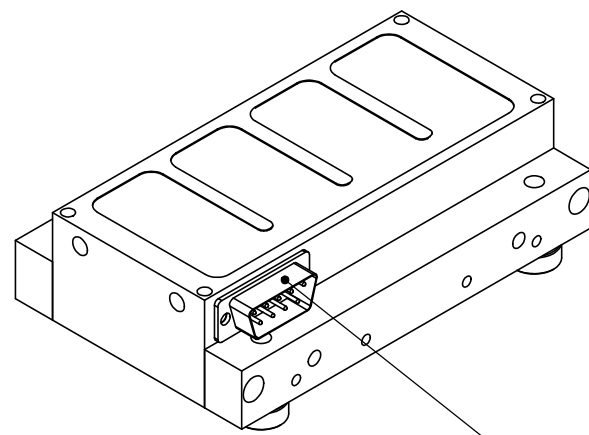

Pin	Function
1	A+
2	B-
3	C+
4	D+
5	Ground
6	B+
7	A-
8	D-
9	C-

MOTOR POWER CONNECTOR

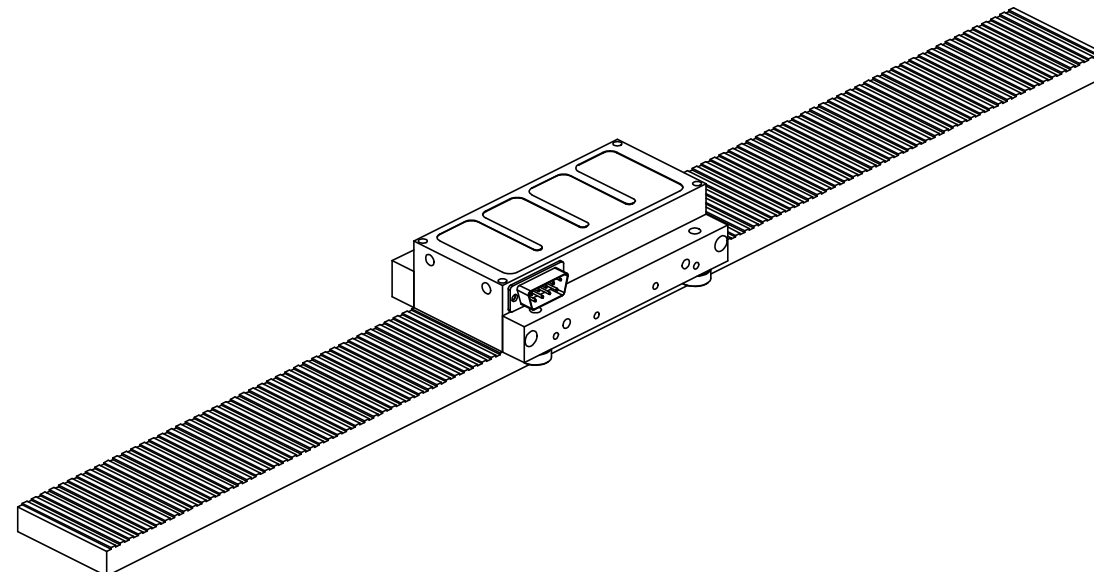

NOTE:  
 1. ONLY ONE AIR INLET MAY BE USED AT A TIME. UNUSED AIR INLET MUST BE PLUGGED WITH 10-32 SET SCREW.