

These drawings and specifications are the property of H2W Technologies, Inc. They are issued in confidence and shall not be reproduced, copied, or used without written permission from H2W Technologies, Inc.

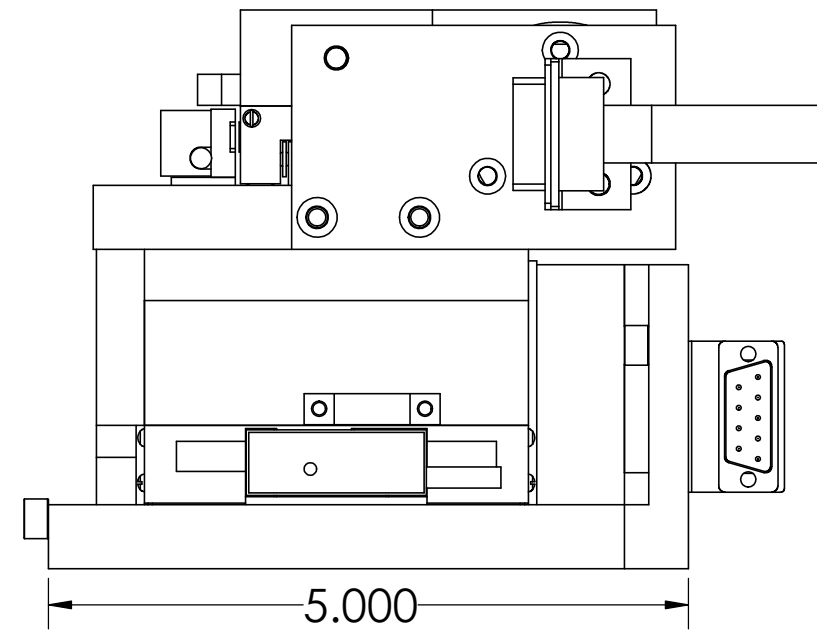
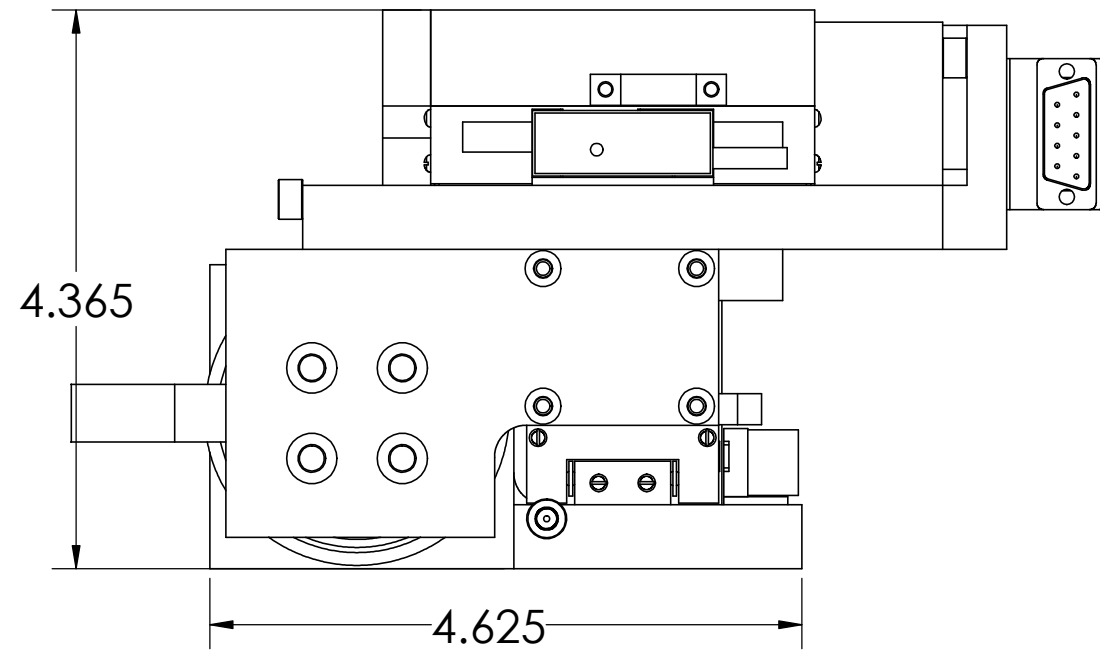
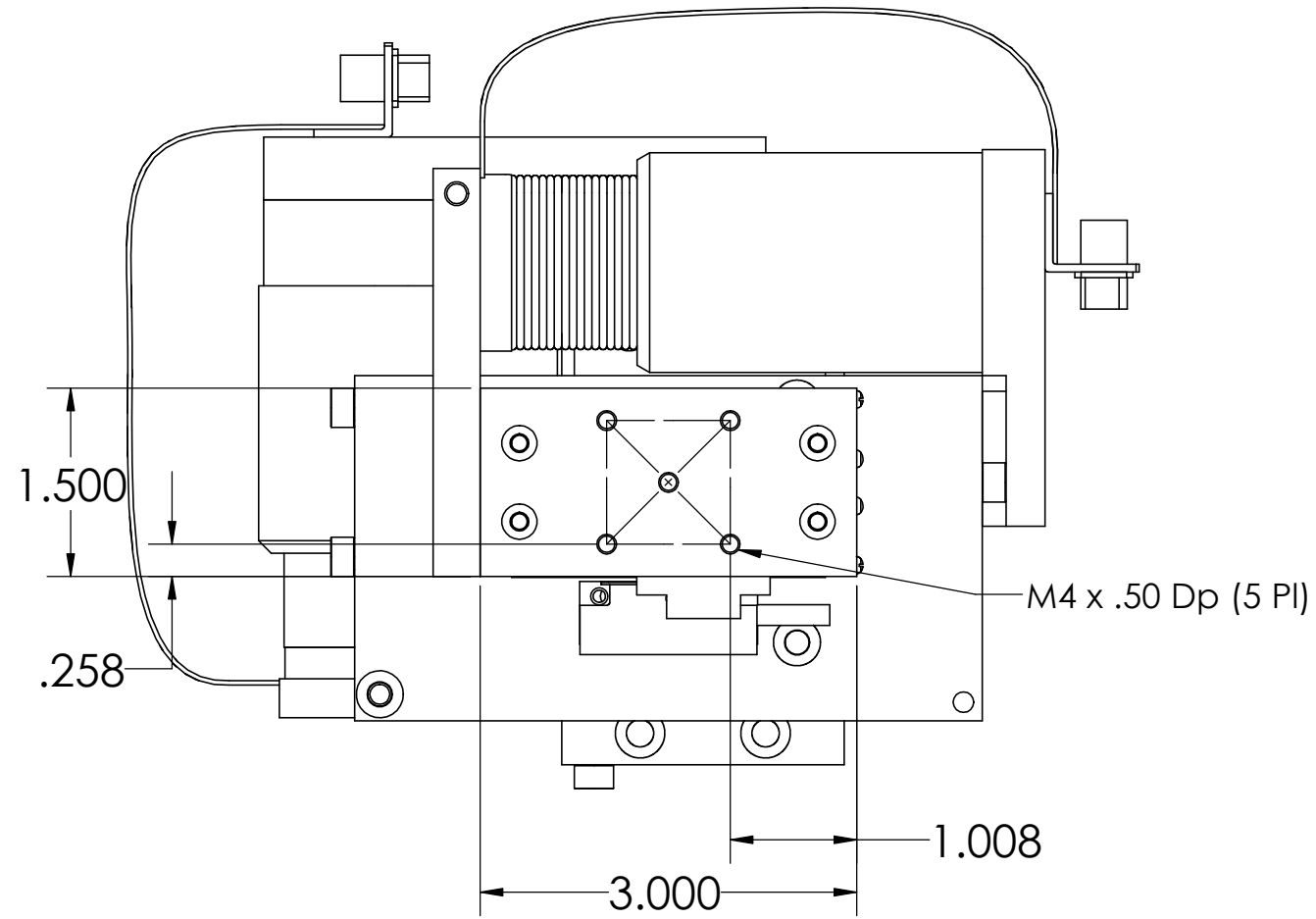

H2W Technologies, Inc.
 26470 Ruether Ave #102 Santa Clarita, CA 91350 USA
 Tel: (661) 251-2081 Fax: (661) 251-2067
 www.h2wtech.com

VOICE COIL POSITIONING STAGE
Model #: VCS15-084-CR-001-XY

UNLESS SPECIFIED OTHERWISE: All dimensions are in inches Standard Tolerances are as follows .XXX ±.005 ANGLES ±1° .XX ±.010 FILLETS AND .X ±.020 CORNERS .010 Remove All Burrs and Sharp Edges		MATERIAL		DATE	
FINISH		DRAWN	DATE	APPROVED	DATE
		OOG	7-22-11	MPW	7-22-11

TITLE	VOICE COIL POSITIONING STAGE	
DWG #	REV	SHEET
31-0281	A	1 of 3

These drawings and specifications are the property of H2W Technologies, Inc. They are issued in confidence and shall not be reproduced, copied, or used without written permission from H2W Technologies, Inc.

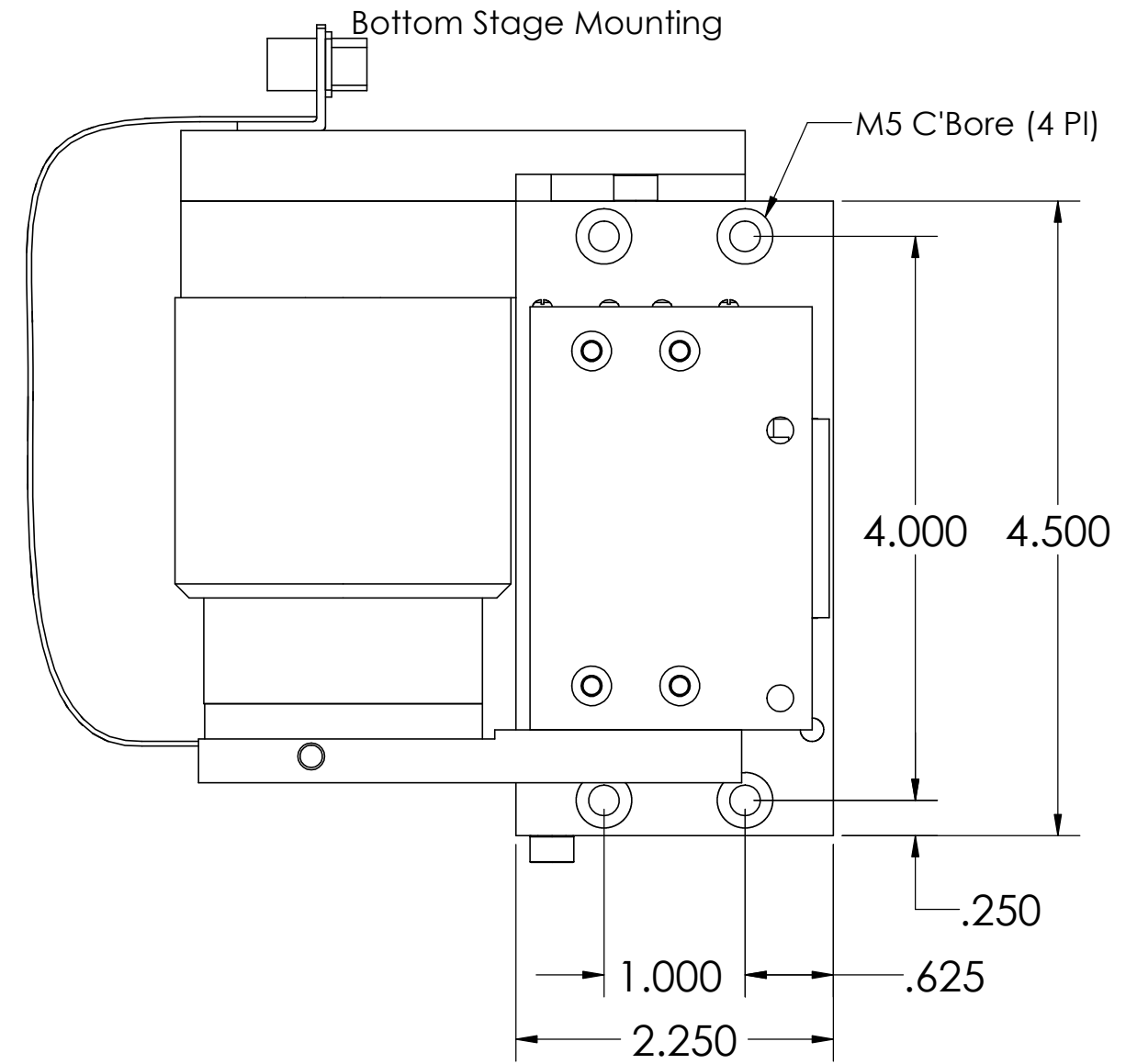
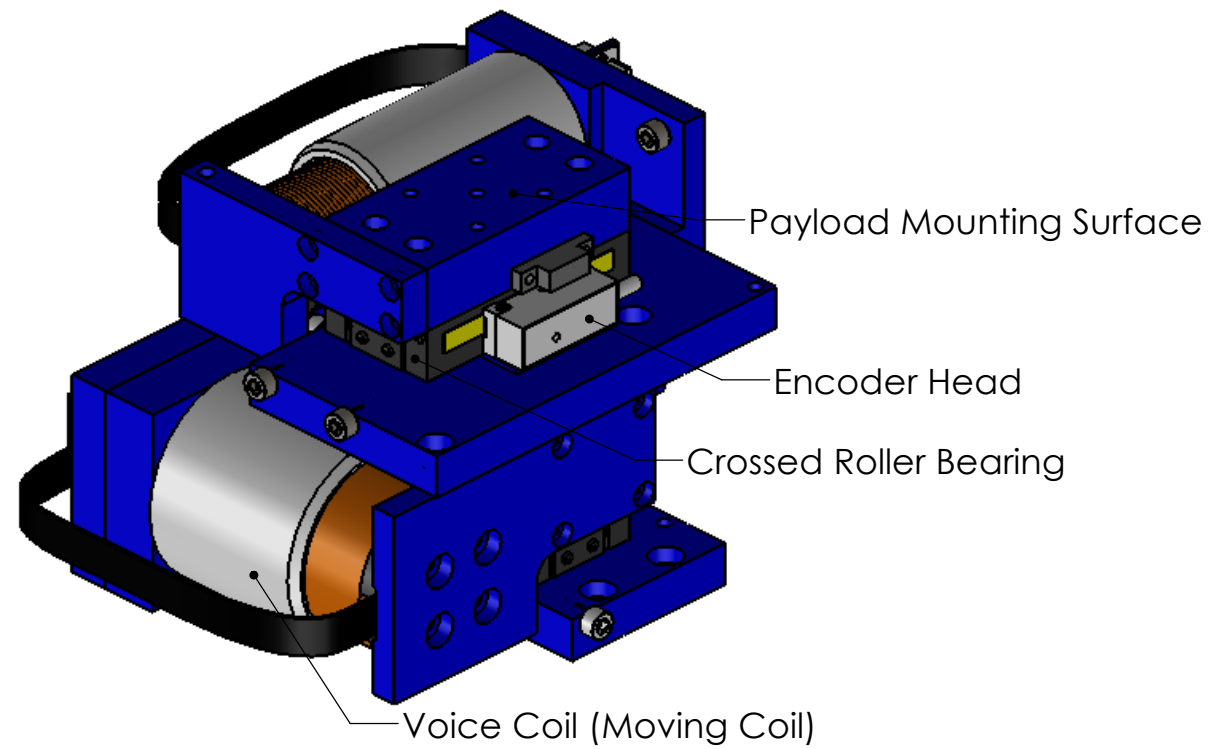
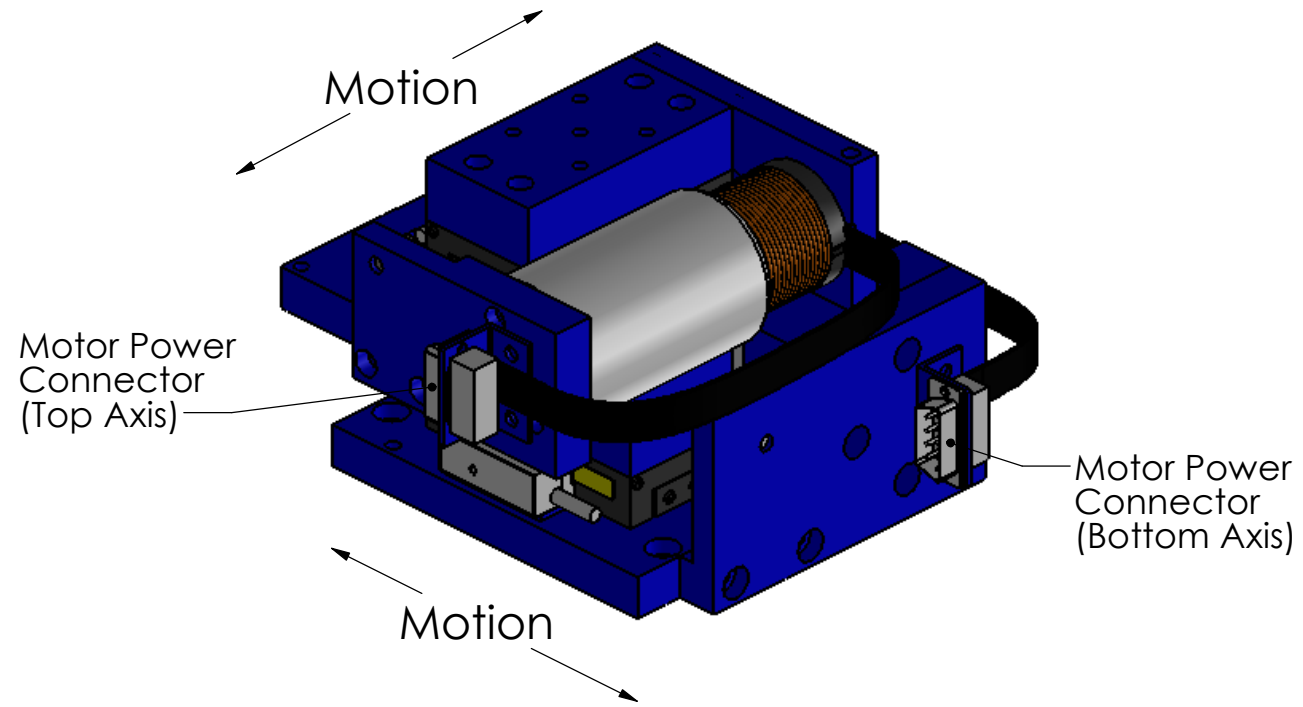

VOICE COIL POSITIONING STAGE SPECIFICATIONS (Bottom Axis)		
Motor P/N (2 Motors)	NCC15-24-050-1R	
Stroke	1.50 in	38.1 mm
Encoder Resolution	0.1 micron	
Encoder Type	Optical	
Bearing Type	Crossed Roller	
Moving Mass	1.33 lbs	604 g
Total Mass	3.91 lbs	1775 g
Resistance @ 20C	1.9 ohms / 7.8 ohms	
Inductance @ 20C	1.4 mH / 5.8 mH	
Electrical Time Constant	0.74 msec	
Motor Constant	1.48 LBS/SQRT(Watt)	6.59 N/SQRT(Watt)
Force Constant	2.04 LBS/Amp or 4.13 LBS/Amp	9.08 N/Amp or 18/38 n/Amp
Back EMF	0.23 V/ips or 0.46 V/ips	9.08 V/m/sec or 18.38 V/m/sec
Force @ 100% Duty	8.4 lbs	37.4 N
Power @ 100% Duty	32 Watts	
Current @ 100% Duty	4.1 Amps / 2.0 Amps	
Force @ 10% Duty	25.2 lbs	112 N
Power @ 10% Duty	291 Watts	
Current @ 10% Duty	12.3 Amps / 6 Amps	
Moving Part	Coil Assembly	

VOICE COIL POSITIONING STAGE SPECIFICATIONS (Top Axis)		
Motor P/N (2 Motors)	NCC20-18-020-1X	
Stroke	2.00 in	50.8 mm
Encoder Resolution	0.1 micron	
Encoder Type	Optical	
Bearing Type	Crossed Roller	
Moving Mass	0.75 lbs	341 g
Total Mass	3.0 lbs	1362 g
Resistance @ 20C	3.50 ohms	
Inductance @ 20C	3.70 mH	
Electrical Time Constant	1.05 msec	
Motor Constant	0.75 LBS/SQRT(Watt)	3.34 N/SQRT(Watt)
Force Constant	1.4 LBS/Amp	6.1 N/Amp
Back EMF	0.2 V/ips	6.1 V/m/sec
Force @ 100% Duty	2.0 lbs	8.9 N
Power @ 100% Duty	7 Watts	
Current @ 100% Duty	1.4 Amps	
Force @ 10% Duty	6.0 lbs	26.7 N
Power @ 10% Duty	64 Watts	
Current @ 10% Duty	4.3 Amps	
Moving Part	Coil Assembly	

NOTE:
Moving and Total Mass are per individual stage.