

STAGE SHOWN AT MIDSTROKE

REVISION TABLE

REV	ECN#	DESCRIPTION	REV BY	APPROVED	DATE
B	---	----	OOG	MPW	1-13-09

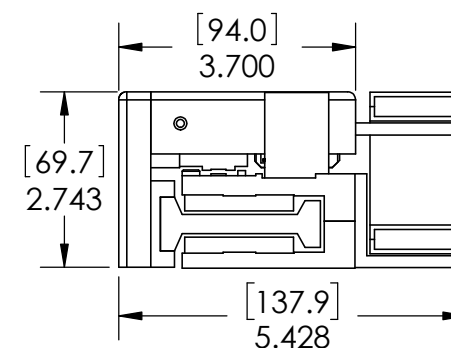
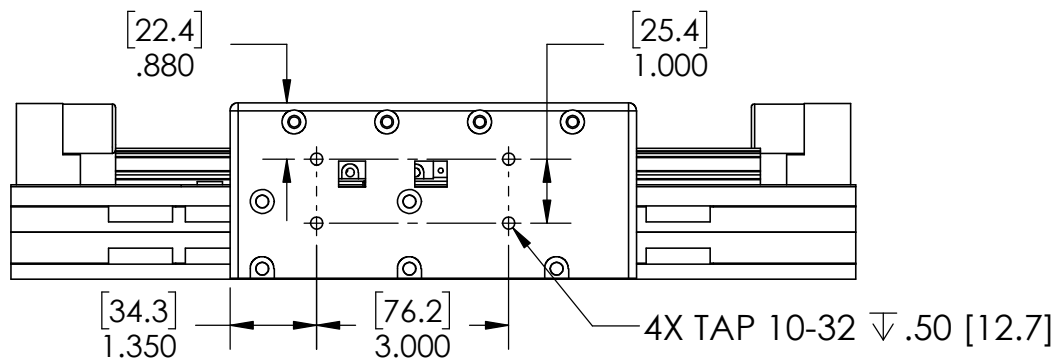
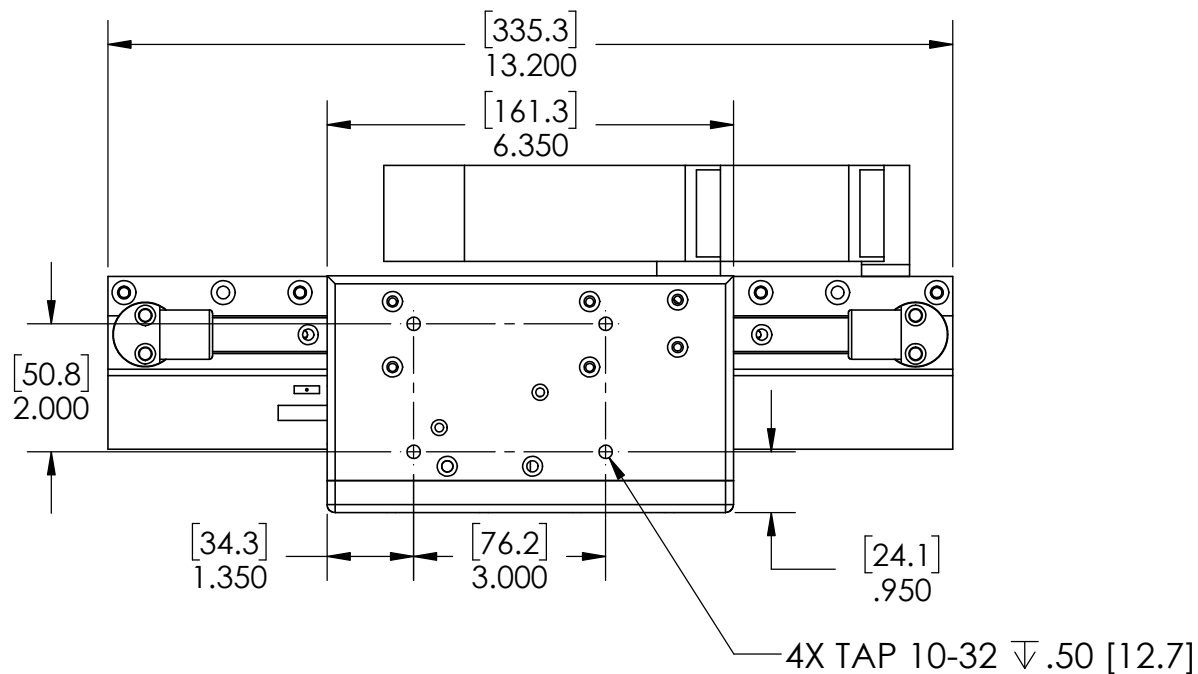

H2W Technologies, Inc.
Santa Clarita, CA 91350 USA
Tel: (661) 291-1620
www.h2wtech.com

These drawings and specifications are the property of H2W Technologies, Inc. They are issued in confidence and shall not be reproduced, copied, or used without written permission from H2W Technologies, Inc.

UNLESS SPECIFIED OTHERWISE:
All dimensions are in inches
Standard Tolerances are as follows
.XXX \pm .005 ANGLES \pm 1°
.XX \pm .010 FILLETS .010
.X \pm .020 CORNERS .010
Remove All Burrs and Sharp Edges

**FOR
REFERENCE
ONLY**

MATERIAL

FINISH

TITLE
Single Rail Positioning Stage Model #:
SRS-004-04-020-X

DWG # **40-0186**

REV **B**

DATE 1-13-09 SHEET 1 of 3

MOUNTING PROVISIONS

PARTS HAVE BEEN HIDDEN
TO SHOWN MOUNTING HOLES

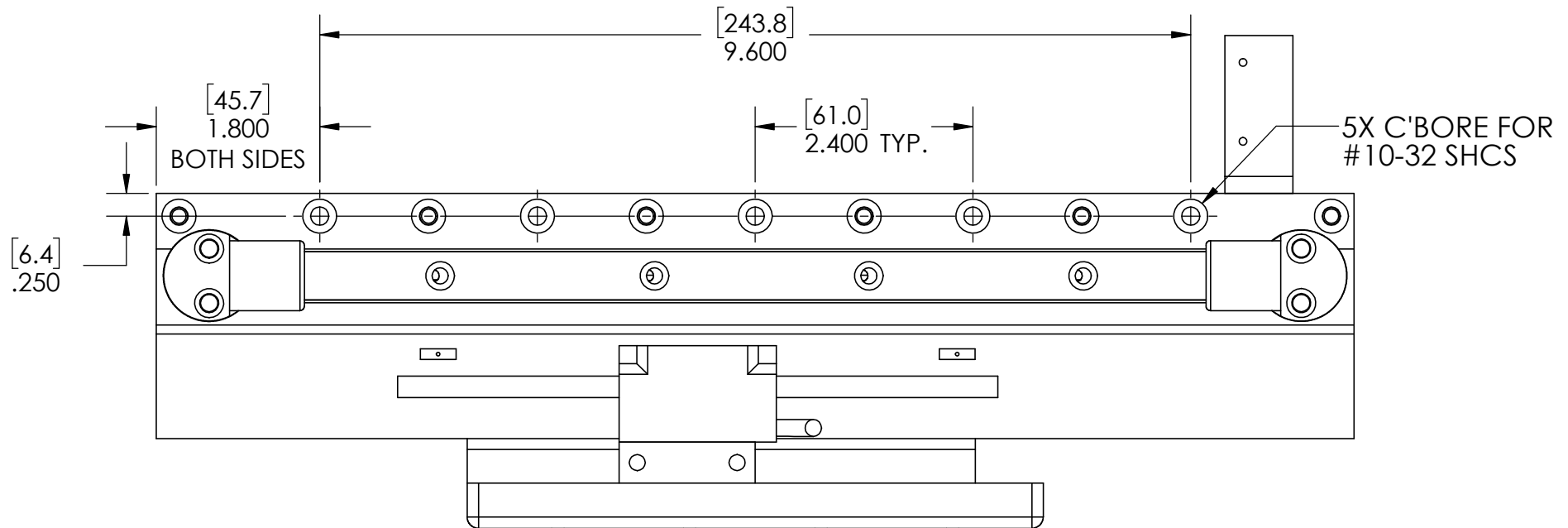

H2W Technologies, Inc.
Santa Clarita, CA 91350 USA
Tel: (661) 291-1620
www.h2wtech.com

These drawings and specifications are the property of H2W Technologies, Inc. They are issued in confidence and shall not be reproduced, copied, or used without written permission from H2W Technologies, Inc.

UNLESS SPECIFIED OTHERWISE:
All dimensions are in inches
Standard Tolerances are as follows
.XXX $\pm .005$ ANGLES $\pm 1^\circ$
.XX $\pm .010$ FILLETS .010
.X $\pm .020$ CORNERS .010
Remove All Burrs and Sharp Edges

**FOR
REFERENCE
ONLY**

MATERIAL

FINISH

TITLE
Single Rail Positioning Stage Model #:
SRS-004-04-020-X

DWG # **40-0186**

REV **B**

DATE 1-13-09 SHEET 2 of 3

1

2

3

4

5

A

B

C

D

A

B

C

D

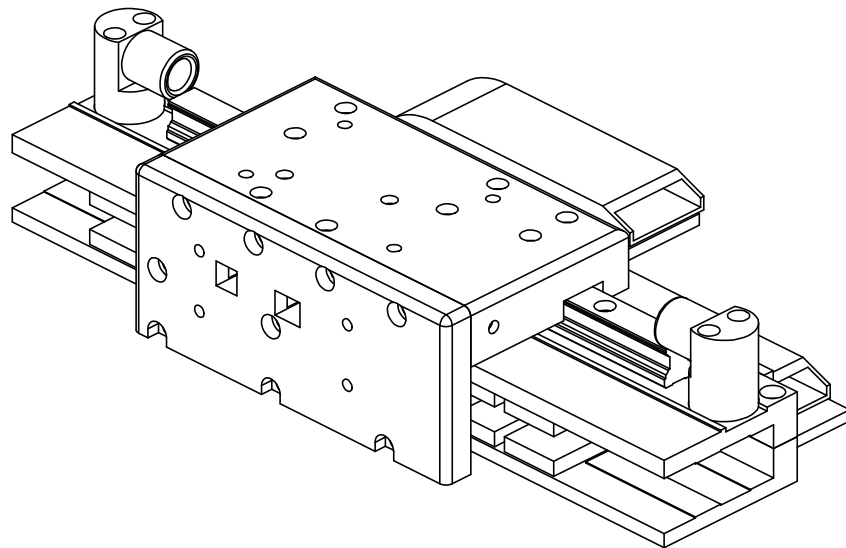
**SINGLE RAIL POSITIONING STAGE SPECIFICATIONS**

Motor P/N	BLDC-02	
Stroke	3.6 in	91.4 mm
Encoder Resolution	1 micron	
Bearing Type	Recirculating Ball	
Moving Mass	4 lbs	1.8 Kg
Total Mass	12.5 lbs	5.7 kg
Resistance @ 20C	8.2 ohms	
Inductance @ 20C	6.0 mH	
Electrical Time Constant	0.7 msec	
Motor Constant	2.12 LBS/SQRT(Watt)	9.43 N/SQRT(Watt)
Force Constant	6.1 LBS/Amp	27.3 N/Amp
Back EMF	0.80 V/ips	31.5 V/m/sec
Force @ 100% Duty	20.6 lbs	91.6 N
Power @ 100% Duty	95 watts	
Current @ 100% Duty	3.4 amps	
Force @ 10% Duty	61.8 lbs	274.8 N
Power @ 10% Duty	846 watts	
Current @ 10% Duty	10.2 amps	
Stage Length	13.2 in	335 mm
Stage Width	5.4 in	137.2 mm
Stage Height	2.74 in	69.6 mm



H2W Technologies, Inc.
Santa Clarita, CA 91350 USA
Tel: (661) 291-1620
www.h2wtech.com

These drawings and specifications are the property of H2W Technologies, Inc. They are issued in confidence and shall not be reproduced, copied, or used without written permission from H2W Technologies, Inc.

UNLESS SPECIFIED OTHERWISE:
All dimensions are in inches
Standard Tolerances are as follows
.XXX ±.005 ANGLES ±.1°
.XX ±.010 FILLETS .010
.X ±.020 CORNERS .010
Remove All Burrs and Sharp Edges

**FOR
REFERENCE
ONLY**

MATERIAL

FINISH

TITLE

Single Rail Positioning Stage Model #:
SRS-004-04-020-X

DWG #

40-0186

REV

B

DATE

1-13-09

SHEET

3 of 3