

STAGE SHOWN AT MIDSTROKE

REVISION TABLE					
REV	ECN#	DESCRIPTION	REV BY	APPROVED	DATE
---	---	Original Drawing	OOG	MPW	12-11-12

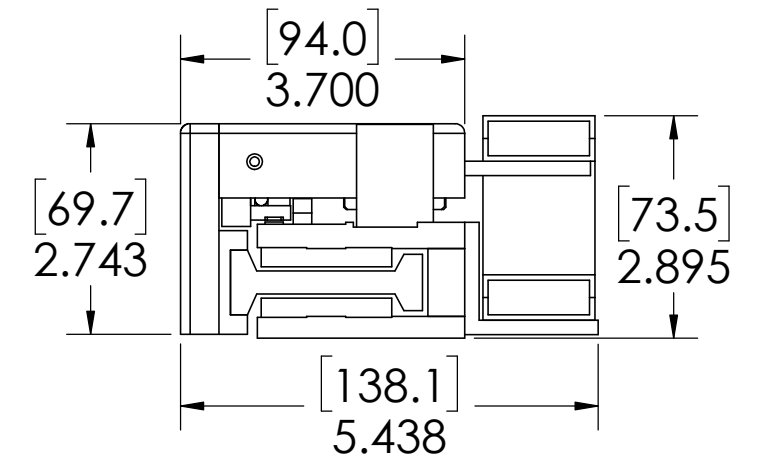
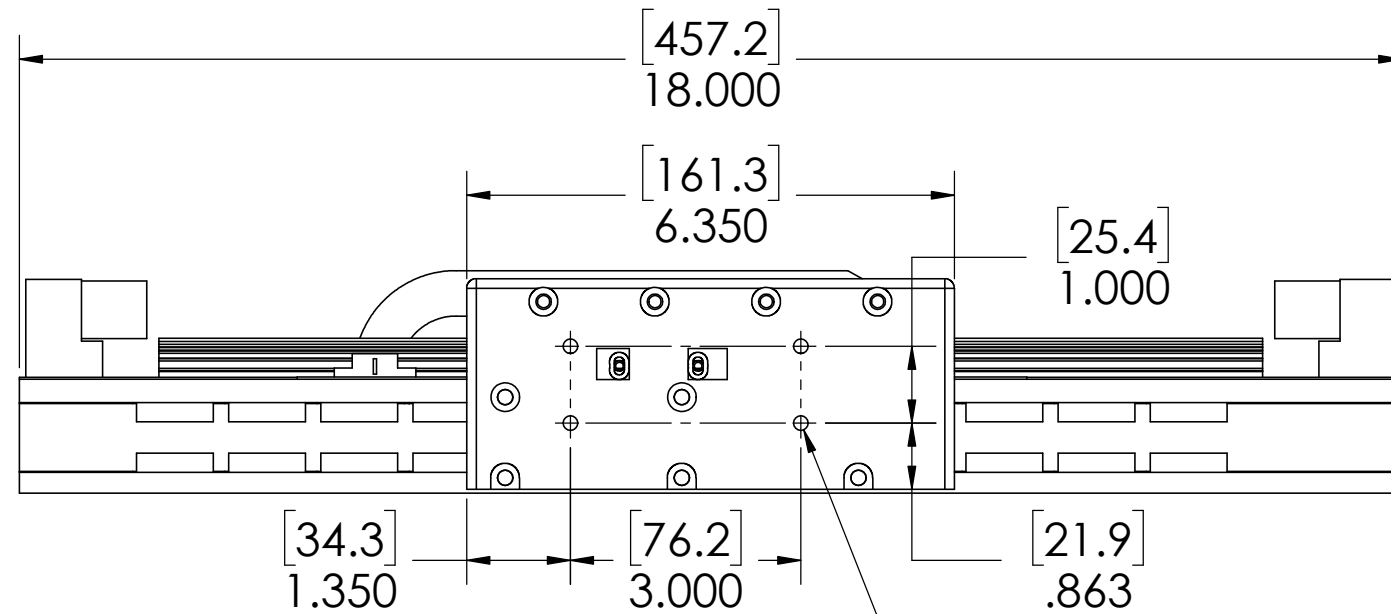
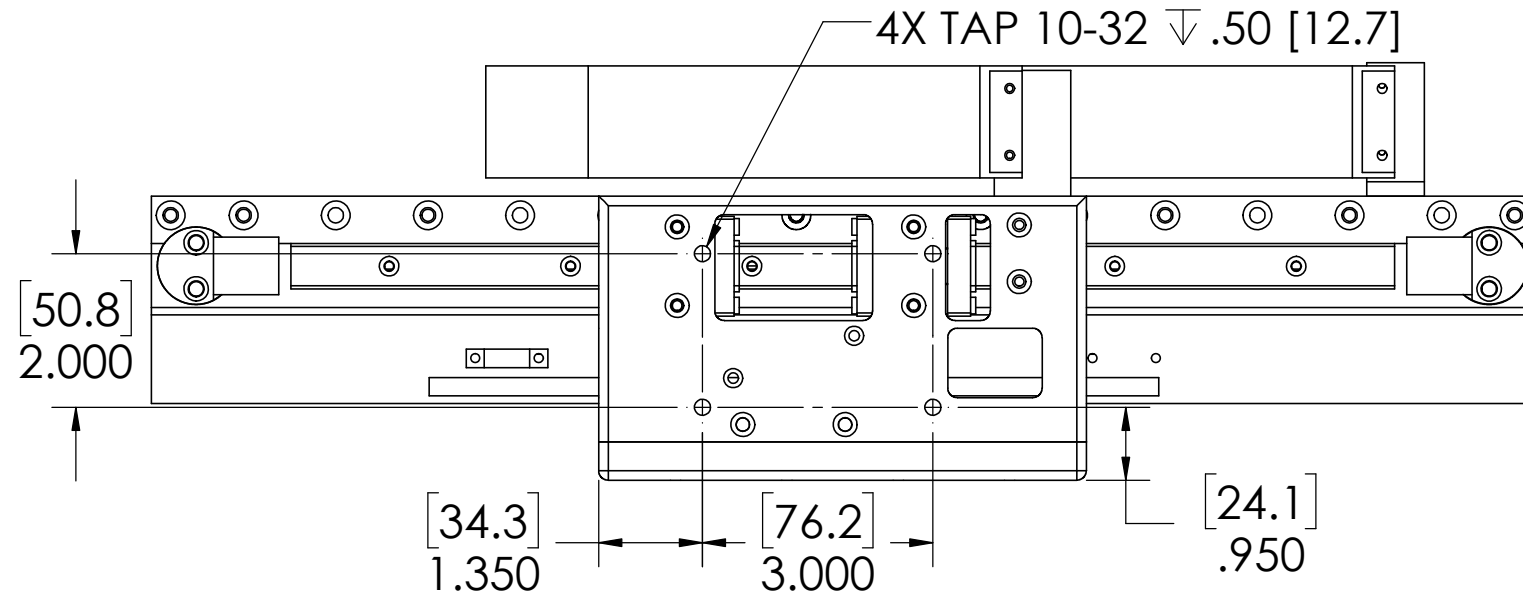

A

A

B

B

C

C

D

D



H2W Technologies, Inc.
 Santa Clarita, CA 91350 USA
 Tel: (661) 291-1620
www.h2wtech.com

These drawings and specifications are the property of H2W Technologies, Inc. They are issued in confidence and shall not be reproduced, copied, or used without written permission from H2W Technologies, Inc.

UNLESS SPECIFIED OTHERWISE:
 Standard Tolerances are as follows:
 .XXX ±.005 ANGLES ±.1°
 .XX ±.010 FILLETS .010
 .X ±.020 CORNERS .010
 Remove All Burrs and Sharp Edges

FOR REFERENCE ONLY

MATERIAL
 FINISH

TITLE
 Single Rail Positioning Stage Model #:
SRS-008-04-020-01V

DWG # **40-0272**
 REV
 DATE 12-11-12 SHEET 1 of 2

1

2

3

4

5

A

A

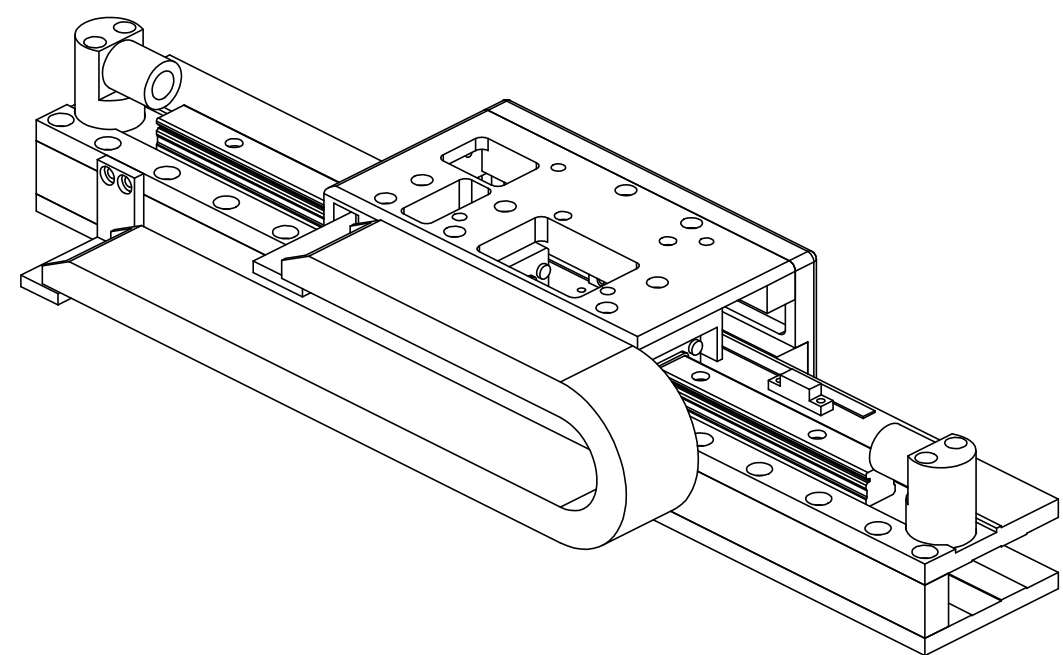

B

B

C

C

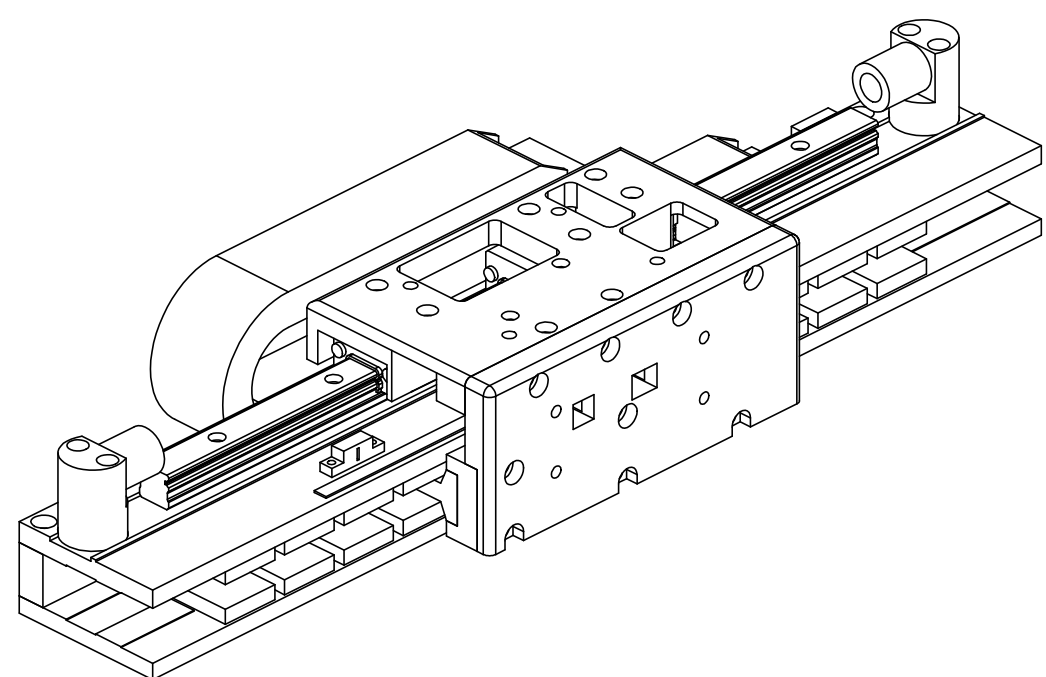

D

D

SINGLE RAIL POSITIONING STAGE SPECIFICATIONS

Motor P/N	BLDC-02	
Stroke	8.25 in	209.5 mm
Encoder Resolution	1 micron	
Bearing Type	Recirculating Ball	
Moving Mass	3.5 lbs	1.6 kg
Total Mass	18.0 lbs	8.2 kg
Resistance @ 20C	8.1 ohms	
Inductance @ 20C	6.0 mH	
Electrical Time Constant	0.7 msec	
Motor Constant	2.12 LBS/SQRT(Watt)	9.43 N/SQRT(Watt)
Force Constant	6.1 LBS/Amp	27.3 N/Amp
Back EMF	0.80 V/ips	31.5 V/m/sec
Force @ 100% Duty	20.6 lbs	91.6 N
Power @ 100% Duty	95 watts	
Current @ 100% Duty	3.4 amps	
Force @ 10% Duty	61.8 lbs	274.8 N
Power @ 10% Duty	846 watts	
Current @ 10% Duty	10.2 amps	
Stage Length	18 in	457.2 mm
Stage Width	5.4 in	137.2 mm
Stage Height	2.85 in	72.4 mm