

1

2

3

4

5

REVISION TABLE

REV	ECN#	DESCRIPTION	REV BY	APPROVED	DATE
---	---	Original Drawing	OOG	MPW	12-8-10

A

A

[9.5]
.375
BOTH SIDES

4X TAP 1/4-20 ∇ .50 [6.4]

4X C'BORE FOR 1/4-20 SHCS

[9.7]
.381 BOTH SIDES

B

B

[178.1]
7.012

[177.8]
7.000

C

C

[381.0]
15.000

[25.4]
1.000
BOTH SIDES

D

D

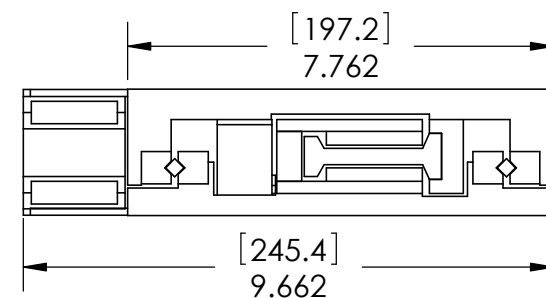
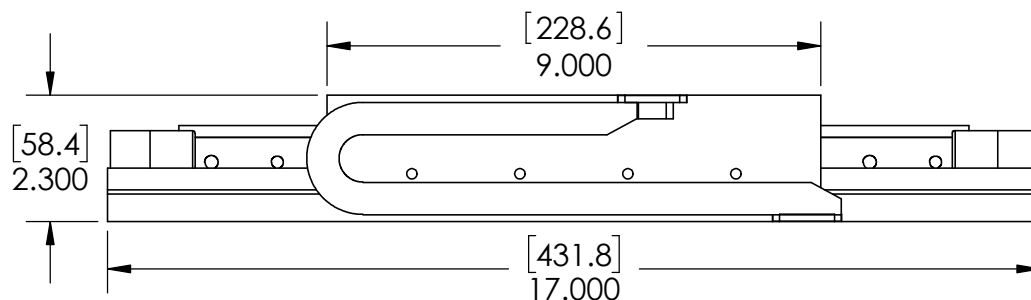

H2W Technologies, Inc.
Santa Clarita, CA 91350 USA
Tel: (661) 291-1620
www.h2wtech.com

These drawings and specifications are the property of H2W Technologies, Inc. They are issued in confidence and shall not be reproduced, copied, or used without written permission from H2W Technologies, Inc.

UNLESS SPECIFIED OTHERWISE:
All dimensions are in inches
Standard Tolerances are as follows
XXX \pm .005 ANGLES \pm 1°
.XX \pm .010 FILLETS .010
.X \pm .020 CORNERS .010
Remove All Burrs and Sharp Edges

**FOR
REFERENCE
ONLY**

MATERIAL

FINISH

TITLE
Crossed Roller Positioning Stage Model #:
XRS-006-10-020-001

DWG # **42-0043**

REV **----**

DATE **12-8-10** SHEET **1 of 2**

1

2

3

4

5

CROSSED ROLLER POSITIONING STAGE SPECIFICATIONS

Motor P/N	BLDC-02	
Stroke	6 in	152.4 mm
Encoder Resolution	0.1 micron	
Bearing Type	Crossed Roller	
Moving Mass	5.42 lbs	2458 g
Total Mass	31.42 lbs	14251 g
Resistance @ 20C	8.2 ohms	
Inductance @ 20C	6.0 mH	
Electrical Time Constant	0.7 msec	
Motor Constant	2.12 LBS/SQRT(Watt)	9.43 N/SQRT(Watt)
Force Constant	6.1 LBS/Amp	27.3 N/Amp
Back EMF	0.80 V/ips	31.5 V/m/sec
Force @ 100% Duty	20.6 lbs	91.6 N
Power @ 100% Duty	95 watts	
Current @ 100% Duty	1.6 amps	
Force @ 10% Duty	61.8 lbs	274.8 N
Power @ 10% Duty	846 watts	
Current @ 10% Duty	6.4 amps	
Stage Length	17 in	431.8 mm
Stage Width	9.66 in	245.36 mm
Stage Height	2.3 in	58.42 mm

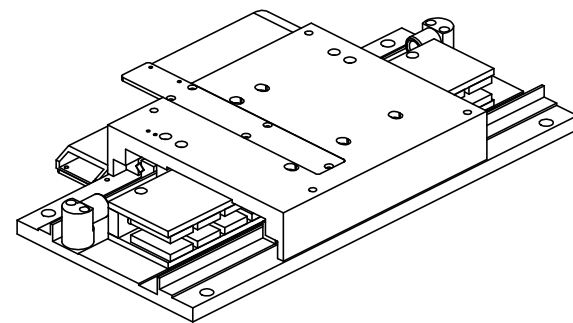
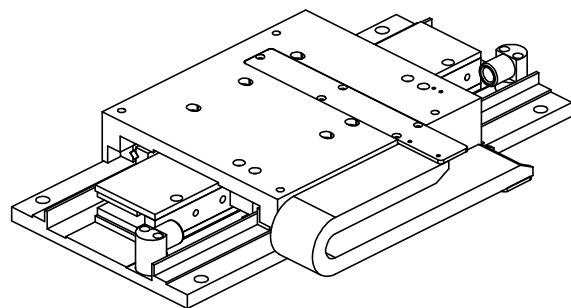

H2W Technologies, Inc.
 Santa Clarita, CA 91350 USA
 Tel: (661) 291-1620
www.h2wtech.com

These drawings and specifications are the property of H2W Technologies, Inc. They are issued in confidence and shall not be reproduced, copied, or used without written permission from H2W Technologies, Inc.

UNLESS SPECIFIED OTHERWISE:
 All dimensions are in inches
 Standard Tolerances are as follows
 .XXX ±.005 ANGLES ±.1°
 .XX ±.010 FILLETS .010
 .X ±.020 CORNERS .010
 Remove All Burrs and Sharp Edges

**FOR
 REFERENCE
 ONLY**

MATERIAL

FINISH

TITLE
 Crossed Roller Positioning Stage Model #:
XRS-006-10-020-001

DWG # **42-0043**

REV ----

DATE 12-8-10 SHEET

2 of 2